

1、SPECIFICATOINS:

Current Rating : 2.0 A
 Voltage Rating : 250V AC
 Contact Resistance : 20mΩ Max
 Insulation Resistance : 1000MΩ Min
 Withstand Voltage : 500V AC/minute
 Operation Temperature : -40° C ~ +105° C

2、MATERIALS:

Contact Material : Copper Alloy
 Contact Plating : Gold/Tin Plated over Ni
 Insulator Material : PA6T BK (UL94V-0)
 Max Processing Temp : 230° C for 30 Seconds
 260° C for 5~10 Seconds

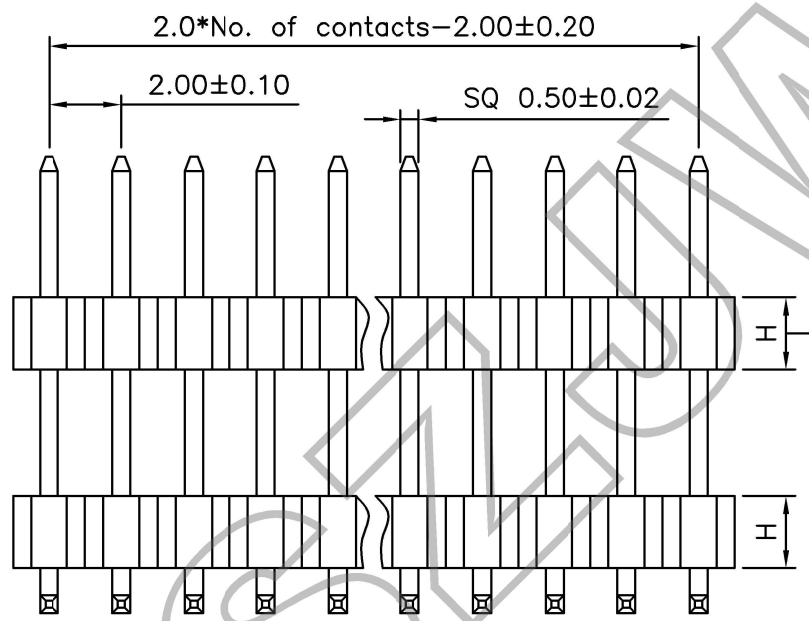

HIGH	PART NO.
2.00	3021-R
1.50	3121-R
1.00	3221-R

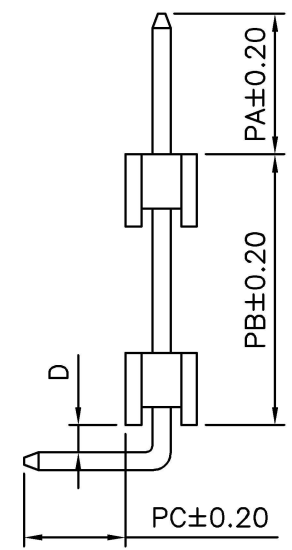

Ordering Informations

3021 XX X N XX R X XXX
 ① ② ③ ④ ⑤ ⑥ ⑦ ⑧

- ① 3021 Pin Header: 2.0 Single Row Series (Add Insulator)
- ② XX NO. of Contacts Per row 02=2PIN 02~40P
- ③ X Insulator Material A=PBT C=PA6T D=PA9T F=LC²
- ④ N Posts W=With Posts N=Without Posts
- ⑤ XX Contact Plated GF=Gold Flash G0=0.80" Gold SN=Tin Hated
- ⑥ R Mounting Type D=DIP R=Right Angle M=SMT Z=Recumbent
- ⑦ X Packing 0=PE Bag T=Tube A=Tray R=Reel+CAP M=Mylar+Reel ...
- ⑧ XXX Serial NO. 001 001~999

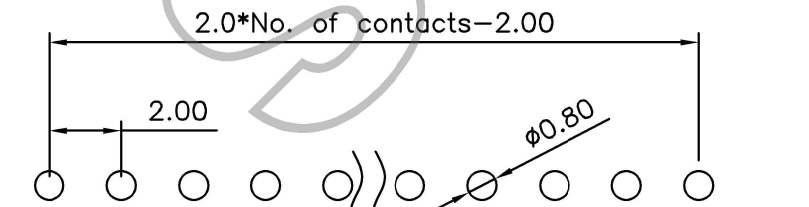

Recommended PCB Layout
 Layout Tolerance ±0.05mm

STANDARD	
PA	4.00
PB	10.0
PC	2.80
D	0.75

TOLERANCES UNLESS OTHERWISE SPECIFIED

.X ~~~~ ±0.30
 .XX ~~~~ ±0.20
 .XXX ~~~~ ±0.10
 ANGLE ~~~~ ±5°

苏州金维益电子科技有限公司
SUZHOU JINWEIYI ELECTRONICS & TECH CO.,LTD

品名规格 PART NO.	2.0排针_单排双塑_rP_DIP_弯插				
物料编码 MATERIAL NO.	3021XXXXXXRXXX	制图 DRAWING	Pop Zhang	2025.03.13	单位 UNITS MM
图号 DWG NO.	20250313003	审核 CHECKED			比例 SCALE N:1
视图 PROJECTION	第一角	批准 APPROVED	Robert Luo	2025.03.13	图幅 SIZE A4

A1	210303001	优化版面	21.03.03	Pop Zhang	CUSTOMER COPY	页码 SHEET	10F1
A0					客户料号		
版本 REV NO.	变更编号 ECN NO.	描述 DESCRIPTION	变更日期 DATE	变更人 CHANGER			