

Recommended PCB Layout  
Layout Tolerance ±0.05mm

HIGH	PART NO.
2.00	3011-M
1.50	3111-M
1.00	3211-M

STANDARD	
PA	4.00
PB	6.00
PC	4.00
D	0.10

TOLERANCES UNLESS OTHERWISE SPECIFIED

.X ~~~~ ±0.30  
.XX ~~~~ ±0.20  
.XXX ~~~~ ±0.10  
ANGLE ~~~~ ±5°

1、SPECIFICATOINS:

Current Rating : 2.0 A  
Voltage Rating : 250V AC  
Contact Resistance : 20mΩ Max  
Insulation Resistance : 1000MΩ Min  
Withstand Voltage : 500V AC/minute  
Operation Temperature : -40° C ~ +105° C

2、MATERIALS:

Contact Material : Copper Alloy  
Contact Plating : Gold/Tin Plated over Ni  
Insulator Material : PA6T BK (UL94V-0)  
Max Processing Temp : 260° C for 30~60 Seconds

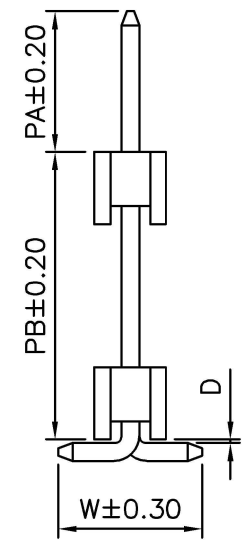

Ordering Informations

3021 XX X N XX M X XXX  
① ② ③ ④ ⑤ ⑥ ⑦ ⑧

- ① 3021 Pin Header: 2.0 Single Row Series (Add Insulator)
- ② XX NO. of Contacts Per row 02=2PIN 02~40P
- ③ X Insulator Material A=PBT C=PA6T D=PA9T F=LC<sup>2</sup>
- ④ N Posts W=With Posts N=Without Posts
- ⑤ XX Contact Plated GF=Gold Flash G0=0.8U" Gold SN=Tin Hated .....
- ⑥ M Mounting Type D=DIP R=Right Angle M=SMT Z=Recumbent
- ⑦ X Packing 0=PE Bag T=Tube A=Tray R=Reel+CAP M=Mylar+Reel ...
- ⑧ XXX Serial NO. 001 001~999

**苏州金维益电子科技有限公司**  
**SUZHOU JINWEIYI ELECTRONICS & TECH CO.,LTD**

品名规格 PART NO.	2.0排针_单排双塑_rP_SMT_立贴				
物料编码 MATERIAL NO.	3021XXNXXMXXX	制图 DRAWING	Pop Zhang	2025.03.13	单位 UNITS MM
图号 DWG NO.	20250313003	审核 CHECKED			比例 SCALE N:1
视图 PROJECTION	第一角	批准 APPROVED	Robert Luo	2025.03.13	图幅 SIZE A4

A1	210303001	优化版面	21.03.03	Pop Zhang
A0				
版本 REV NO.	变更编号 ECN NO.	描述 DESCRIPTION	变更日期 DATE	变更人 CHANGER

客户料号	
CUSTOMER COPY	页码 SHEET 10F1