

HIGH	PART NO.
2.00	3011-Z
1.50	3111-Z
1.00	3211-Z

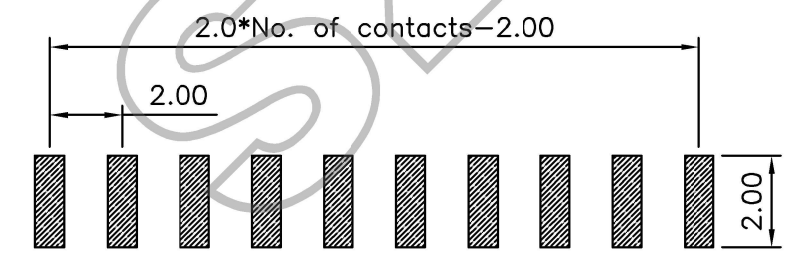
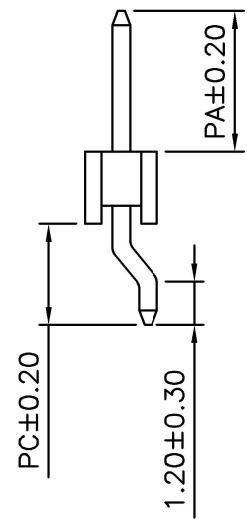

Recommended PCB Layout  
Layout Tolerance ±0.05mm

STANDARD	
PA	4.00
PC	2.80
D	0.10

TOLERANCES UNLESS OTHERWISE SPECIFIED  
.X ~~~~ ±0.30  
.XX ~~~~ ±0.20  
.XXX ~~~~ ±0.10  
ANGLE ~~~~ ±5°

1、SPECIFICATOINS:

Current Rating : 2.0 A  
Voltage Rating : 250V AC  
Contact Resistance : 20mΩ Max  
Insulation Resistance : 1000MΩ Min  
Withstand Voltage : 500V AC/minute  
Operation Temperature : -40° C ~ +105° C

2、MATERIALS:

Contact Material : Copper Alloy  
Contact Plating : Gold/Tin Plated over Ni  
Insulator Material : PA6T BK (UL94V-0)  
Max Processing Temp : 260° C for 30~60 Seconds

Ordering Informations

3011 XX X N XX Z X XXX  
① ② ③ ④ ⑤ ⑥ ⑦ ⑧

- ① 3011 Pin Header: 2.0 Single Row Series
- ② XX NO. of Contacts Per row 02=2PIN 02~40P
- ③ X Insulator Material A=PBT C=PA6T D=PA9T F=LC<sup>2</sup>
- ④ N Posts W=With Posts N=Without Posts
- ⑤ XX Contact Plated GF=Gold Flash G0=0.8u" Gold SN=Tin Hated .....
- ⑥ Z Mounting Type D=DIP R=Right Angle M=SMT Z=Recumbent
- ⑦ X Packing 0=PE Bag T=Tube A=Tray R=Reel+CAP M=Mylar+Reel ...
- ⑧ XXX Serial NO. 001 001~999

**苏州金维益电子科技有限公司**  
**SUZHOU JINWEIYI ELECTRONICS & TECH CO.,LTD**

品名规格 PART NO.	2.0排针_单排_nP_SMT_贴片				
物料编码 MATERIAL NO.	3011XXXXXXZXXX	制图 DRAWING	Pop Zhang	2025.03.13	单位 UNITS MM
图号 DWG NO.	20250313003	审核 CHECKED			比例 SCALE N:1
视图 PROJECTION		批准 APPROVED	Robert Luo	2025.03.13	图幅 SIZE A4

A1	210303001	优化版面	21.03.03	Pop Zhang	CUSTOMER COPY	页码 SHEET	10F1
A0					客户料号		
版本 REV NO.	变更编号 ECN NO.	描述 DESCRIPTION	变更日期 DATE	变更人 CHANGER			